

FACADE NORD  
-PEAU EXTERIEURE-

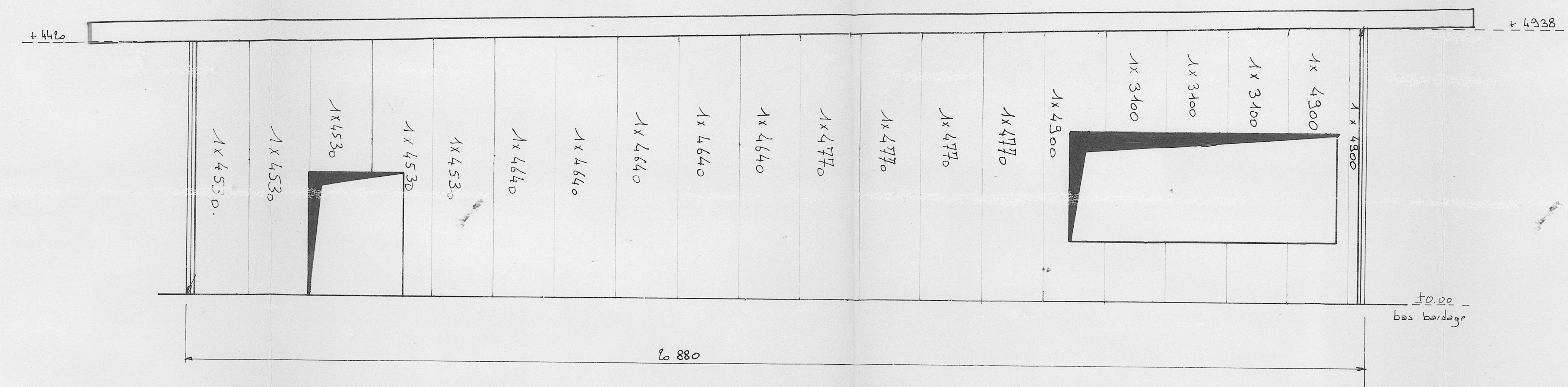

FACADE NORD  
-PEAU INTERIEURE-

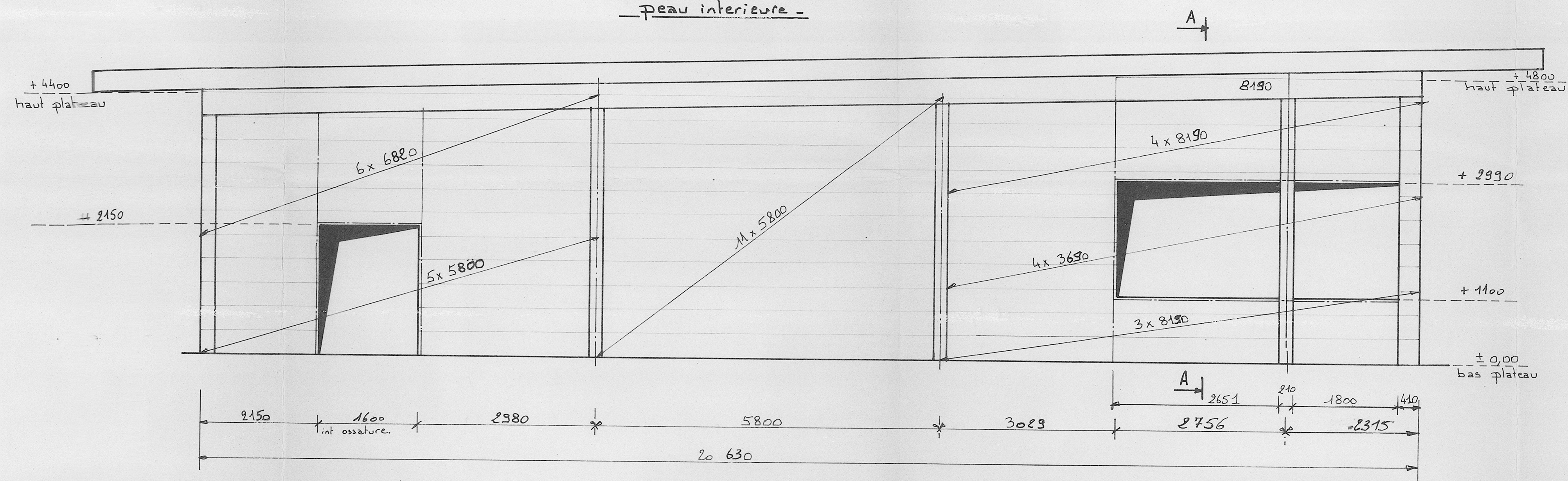

FACADE SUD  
-PEAU EXTERIEURE-

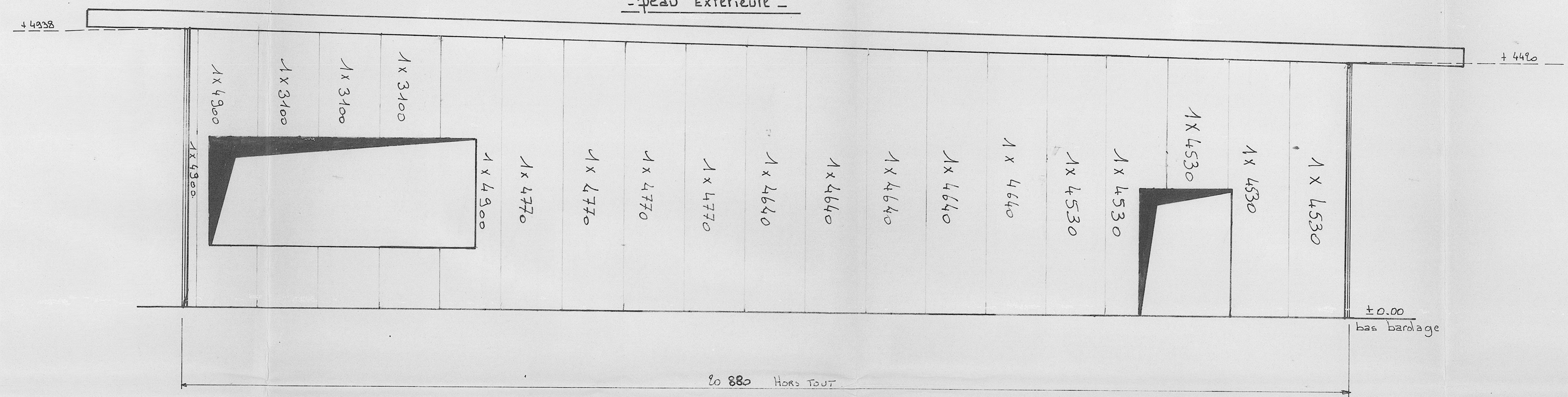

FACADE SUD  
-PEAU INTERIEURE-

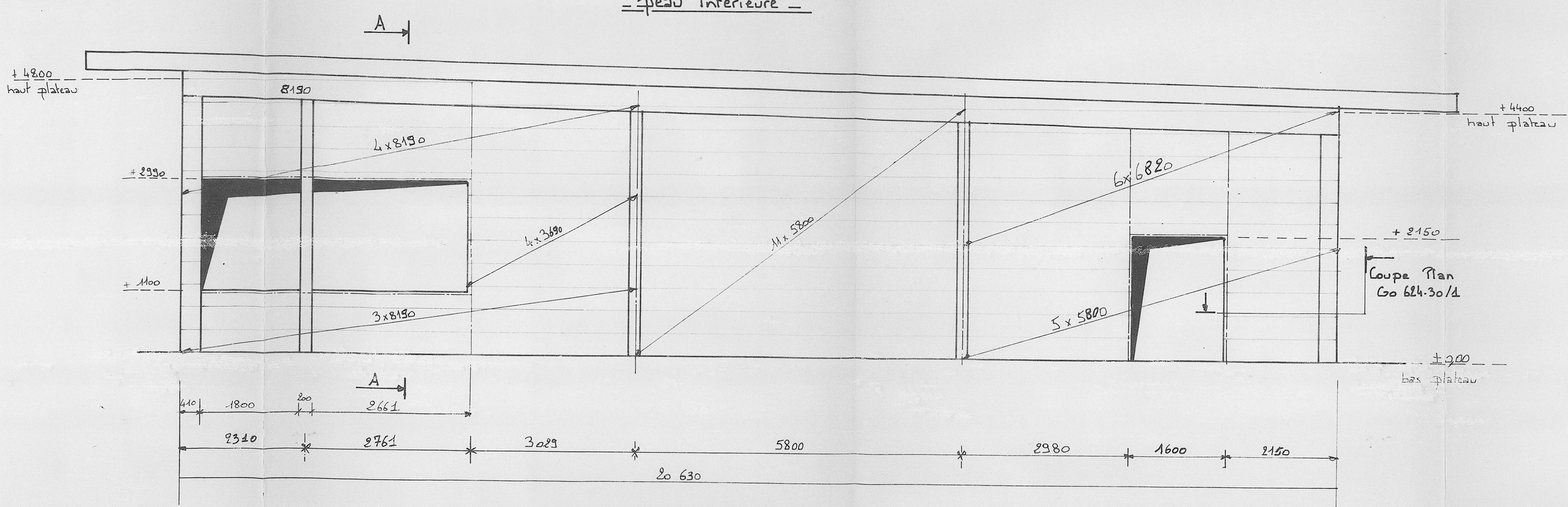

BARDAGE ACOUSTIQUE DOUBLE PEAU "THERMOSONA"

-Peau interieure-

Plateau perforé 90/400 - ep 75/400 - Galva

-Peau exterieure-

NERVECO 4.25.1070 - ep 75/400 - prelaqué blanc SLP 6709 - 25µ.

**D.O.E**

|                                                                                                                                           |      |      |      |                                                                   |               |        |         |
|-------------------------------------------------------------------------------------------------------------------------------------------|------|------|------|-------------------------------------------------------------------|---------------|--------|---------|
| Indice                                                                                                                                    | 7/12 | Date | 7/12 | Peau exterieure de bardage                                        | Modifications | Etabli | Verifié |
| CLIENT                                                                                                                                    |      |      |      | OBJET                                                             |               |        |         |
| Conseil Regional<br>De Bourgogne                                                                                                          |      |      |      | Campus Dijon<br>Salle Modulable<br>21 Dijon<br>Calepinage Bardage |               |        |         |
| COMMANDE                                                                                                                                  |      |      |      | Facade Nord - Facade Sud                                          |               |        |         |
| Go 624.30                                                                                                                                 |      |      |      | Go 624.30                                                         |               |        |         |
| Date 25/10/95                                                                                                                             |      |      |      | Echelle 1/50                                                      |               |        |         |
| Dessiné par Avril                                                                                                                         |      |      |      | No PLAN                                                           |               |        |         |
| Verifié par                                                                                                                               |      |      |      | Go 624.30/13                                                      |               |        |         |
| <p><b>SMAC</b> <b>Acteroid</b></p> <p>100 rue de la République - 21000 Dijon - France<br/>Tél : 03 80 23 10 00 - Fax : 03 80 23 10 01</p> |      |      |      |                                                                   |               |        |         |